









Département de la Sarthe (72)
Commune de St Paterne
Lotissement "La Bousselière"

Plan de composition

-  Zone d'implantation des habitations
-  Zone d'implantation des annexes
-  Haie existante conservée
-  Entrée de lots obligatoires
-  chaussée
-  Trottoir
-  Sente piétonne
-  Borne lumineuse

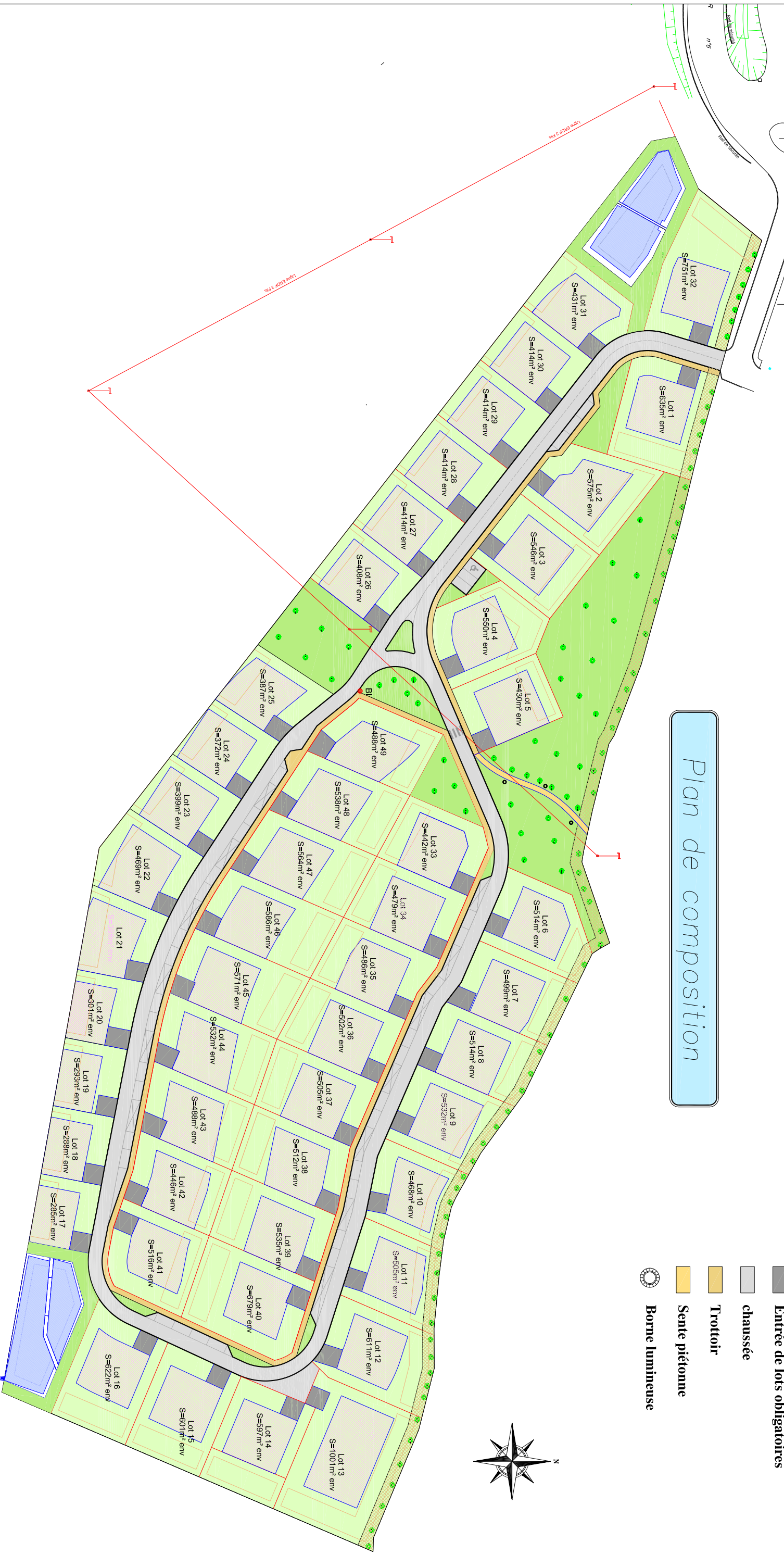

AGETHO-CONSEILS
C. THOMAS - M. THOMAS - Ingénieurs E.S.G.T.
GÉOMÈTRES - EXPERTS ASSOCIÉS
 Bureau principal 35-37, rue Louis Rousier - B.P. 248
 61007 ALENCON Cedex
 02 33 80 21 30
 02 30 96 08 15
 alencon-geometre@agetho-conseils.fr
 Successeurs de M. LASCOUTOUNAS, M. GOURDEAU et de ATEC Sarl
 www.agetho-conseils.com

